

## Summary Report – November 2, 2016 Meeting NMSU Campus Planning Committee

Facilities and Services, Large Conference Room , 3:30 – 4:15 pm

**Present:** members + F&S resource staff (list at end of report)

Report by Heather Zack Watenpaugh  
Chair, Campus Planning Committee

See attached presentation for agenda and individual items.

### Recommendations of the committee:

#### 1. Information Item: Master Planning Process

Initial Timeline for Master Plan Development:

**April 2016 to September 2016-** Gather Plan Process Development Team, set up communication strategy and plan static content design.

**October 2016 to January 2017-** Polling of stakeholders/public (October 2017) and analysis of input (November).

10/13/16- Presented at Employee Council Meeting

10/20/16- Presented at ASNMSU Senate Chambers

11/03/2016- Presented to Faculty Senate

**February 2017 to March 2017-** Compilation of data (February 2017) and complete draft (March 2017).

**April 2017 to May 2017-** Distribute pre-final draft to Chancellor/BOR for review (April 2017), edit and finalize.

**June 2017-** Publish finalized plan.

#### 2. Action Item: Alumni and Visitor Center Addition

**Building #44: Alumni and Visitor Center**

Architect **ASA Architects (2002 addition)**

**WDG Architects (proposed new work)**

Building Number **44**

Date of Construction **1928,**

Major Additions **1981, 2003, 2006**

Lighting Renovation **2009**

**Important Features:**

Single story massing with L-shaped plan

Slightly gabled roof with overhang

Red tiled roof at portions of building

Interior courtyard

Canopy at entrance



The original building was constructed in 1928. The former use of the building was as the University Police Station. The new Police Station was constructed in 2003, along with a major renovation/addition building to create the Alumni & Visitor Center building. The Zuhl Collection was incorporated into the structure in 2003. This proposed addition will extend the gallery space, provide storage, and possibly a new classroom, curator's office and restrooms, as funding allows.



Image of addition from College Drive

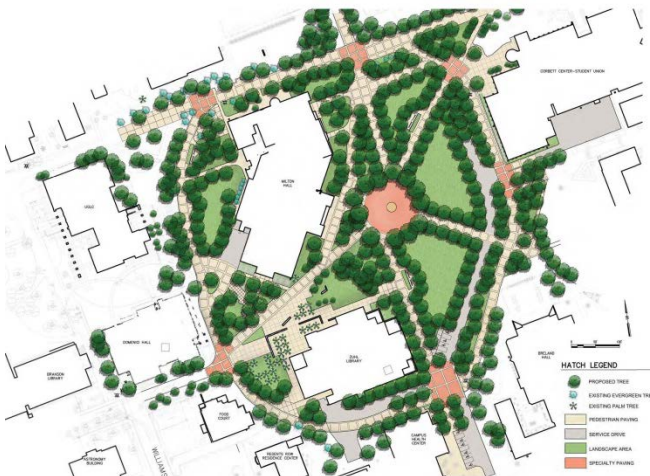

Image of new entry at addition.

**Recommend approval, for Alumni and Visitor Center Addition.**  
*(Moved to vote; seconded; all in favor)*

**3. Item: Hardman and Jacobs Undergraduate Learning Center Green (McFie Circle Phase 2)-**

McFie Circle was presented to the Campus Planning Committee on 9/03/14. The Committee recommends approval of the design concept and Phase 1 at this time but with the condition that the design be re-evaluated and studied after Phase 1 is complete and has had some time to indicate how it works, before proceeding with Phases 2 and 3. Issues such as parking, wheeled vehicle access and safety issues need to be addressed satisfactorily before proceeding with the rest of the project.



Included in the McFie Circle Phase 2 is the alternate, if funding allows for a Desert Garden.



Also proposed as part of the Desert Garden is a Prefabricated Shade Structure. Options for the shade structure were discussed.



Option A - Ocotillo shade pavilion, approximate cost \$16,540



Option B - Marana shade pavilion, approximate cost \$8,970 (will require alterations to partially enclose sides/back of structure).



Option C - Half hexagon shade pavilion, approximate cost \$13,750.

The three options were discussed. Option B and C would require modifications for a more enclosed feel at the sides of the structure, but workable with lower purchase cost. The CPC recommended against Option C. Option A and B (with modifications) were acceptable. Option A was the preferred option.

**Recommend approval, of Hardman and Jacobs Undergraduate Learning Center Green (HJULCG), McFie Circle Phase 2, with preference of Option A over Option B, and against Option C.**  
*(Moved to vote; seconded; all in favor)*



